

SAFETY BABY BED

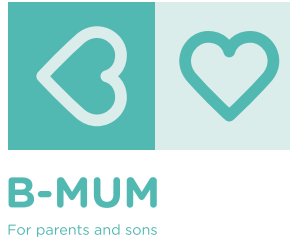

About 5,000 infants die each year from Sudden Death Syndrome (SIDS). This is the main cause of death in Western countries among children between one and 12 months.

<http://br.guiainfantil.com/saude/204-morte-subita/386-morte-subita-dos-bebes.html>

The causes are still unknown but already some risk factors have been identified, as well as some preventive measures; namely, placing the baby in bed on its back on a slightly inclining mattress with without props or dolls, etc.

According to the recommendations of the World Health Organisation (WHO) while sleeping the head of the baby should not be covered with bedding. Studies also show that between 16 and 22% of children, who die from sudden death have their heads covered by bedding.

Because this is so worrying for parents, SafetyBabyBed has emerged as a safety system in the form of bed sheets with a specific design to help parents to become more aware of safety issues. The aim of SafetyBabyBed is to reduce the risk of suffocation of babies by bedding in their first months of life, as the baby has no perception of any obstruction and has yet to develop its defensive reflexes.

For further **bibliographic information** you can consult (among many references) the following:

(1) https://www.babycenter.com/O_sids-and-baby-sleep-safety_419.bc#articlesection4

(2) <https://www.cdc.gov/sids/data.htm>

(3) <http://pediatrics.aappublications.org/content/128/5/e1341.full>

(4) <https://www.healthychildren.org/English/ages-stages/baby/sleep/Pages/A-Parents-Guide-to-Safe-Sleep.aspx>

(5) http://www.mirror.co.uk/news/uk-news/baby-sleep-aids-linked-12-11294693?ICID=FB_mirror_main

Operating mode

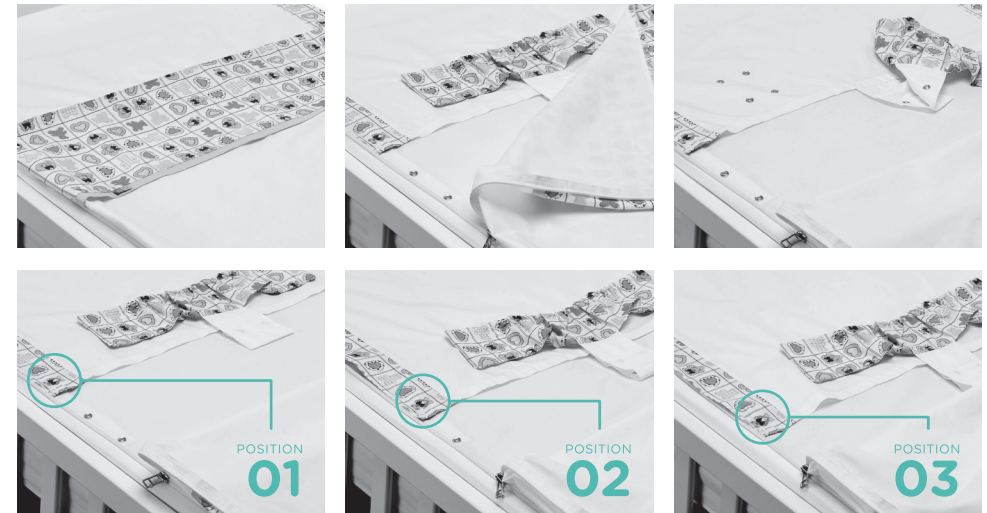

The **SafetyBabyBed** has a removable safety accessory with 3 possible positions that allow for the growth of the baby from birth to approximately six months. If you use it from the birth, you will probably use the accessory in position 1. As the baby grows, the safety attachment moves down to positions 2 and 3, respectively, although it is important to bear in mind that the accessory should not be moved down until the baby can be left with the top sheet under its armpits, which is more recommended, or level with its shoulders. When the defence mechanism of your baby is already working well or it no longer tolerates the recommended position (belly up or Supine Sleep Position), the safety system can be completely withdrawn, although this is not recommended before the age of at least six months. After about six months the bed sheets of the SafetyBabyBed can be used alone as a practical way of making the bed.

For more information or questions see: www.b-mum.com

Notes:

- Read the instructions and notes carefully before use and save for future reference;
- Before using the SafetyBabyBed, check that the pressure springs are all in good condition and in case of any malfunction please inform our company, so that we can replace them;
- ALWAYS take care to ensure that the pressure springs are firmly pressed in, so as not to detach the removable SAFETY attachment, which prevents the baby from sliding under the sheets;
- The SafetyBabyBed does not replace or dispense with adult supervision;
- It is not a medical device;
- Use from birth to six months with the safety accessory (or until the baby tolerates the recommended supine position) and from six months to four years without the safety accessory (or until the baby leaves the crib);
- The SafetyBabyBed must be attached to the mattress and the safety system must be adjusted to the position appropriate for the size of your child to ensure that the top sheet is under its armpits, as recommended, or no higher than its shoulders;
- The pillowcase - supplied in the original packaging - is only recommended for use from 12 months onwards;
- Do not leave the child alone;
- The SafetyBabyBed DOES NOT GUARANTEE AVOIDANCE of Sudden Death Syndrome (SIDS). As mentioned above, the SafetyBabyBed, due to its design, is intended to REDUCE the risk of suffocation, which is one of the SIDS risk factors, as it prevents the baby from sliding down into the bed. It should be remembered that B-Mum shall not be liable for any event related with this or any other syndrome.